

FINAL PLAT
SUMMIT LAKE VILLAS, SECTION 1

A PLANNED UNIT DEVELOPMENT
 BEING A PART OF THE WEST 1/2, SEC. 34, T9N - R2W, L.M.
 NORMAN, CLEVELAND COUNTY, OKLAHOMA



SCALE: 1" = 60'



5.89°59'48"E. - 700.00'
 H.W. COR. - SEC. 34,
 19N. R2W. 1.W.
 50.00'
 NORTH

5.89°59'48"E. - 649.84'
ALAMEDA STREET
 R.O.V. EASEMENT - BOOK 89 PAGE 574

N60°00'00"E - 344.54'
 UNPLATTED

S 00°00'00"E - 281.05'
 SUMMIT LAKE VILLAS
 SEC. 1

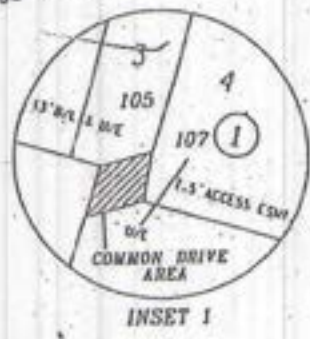

N89°59'40"W - 391.76'

180.84'
 S79°00'00"W
 150.00'
 S25°00'00"W

S39°54'12"E - 666.90'

N01°10'33"W - 314.60'

584°06'16"W - 281.27'
 64.44'
 N05°53'44"W

584°05'16"W - 416.69'

ROADWAY, DRAINAGE & USE
 (SEPARATE INSTRUMENT)

UNPLATTED
312

Red - Do weekly

*Red areas, west fence line
 and area I may be done
 w/ 10th trimmer*